

F



HIGH PRESSURE WASHING

Type F flat fan jet nozzles are designed for high pressure washing applications. The inner profile design allows for even jet distribution which results in an effective and uniform cleaning action over the surface being processed.

All nozzles are finished on high precision machinery assuring close manufacturing tolerances for capacity within +/- 3% of the nominal value, and they are made out of AISI 416 grade stainless steel, bright-hardened through the body (not cheaply surface hardened). Nozzles shown in this catalogue have a tapered thread according to BSPT standards, while NPT threaded nozzles are available for other markets outside Europe. Typical applications are machines and plants for car washing processes, industrial cleaning processes, and pressure washers.

Material C2 AISI 416 Stainless steel, hardened

0°			15°			25°			40°			65°			Code	Eqv. DIA mm	Nozzle capacity at different pressure values							lpm bar
FAA	FBA	FXA	FAB	FBB	FXB	FAD	FBD	FXD	FAL	FBL	FXL	FAR	FBR	FXR			20	30	50	70	100	150	200	
														1460	0.70	2.0	2.4	3.1	3.7	4.4	5.4	6.2		
														1686	1.12	3.0	3.6	4.7	5.5	6.6	8.1	9.3		
														1930	1.28	4.1	5.0	6.5	7.7	9.2	11.3	13.0		
														2103	1.35	4.6	5.6	7.3	8.6	10.3	12.6	14.6		
														2116	1.42	5.1	6.2	8.1	9.5	11.4	14.0	16.1		
														2126	1.47	5.6	6.9	8.9	10.5	12.6	15.4	17.8		
														2138	1.54	6.1	7.4	9.6	11.4	13.6	16.7	19.2		
														2149	1.60	6.7	8.2	10.5	12.5	14.9	18.2	21.1		
														2160	1.66	7.2	8.8	11.3	13.4	16.0	19.6	22.6		
														2170	1.71	7.6	9.3	12.0	14.2	17.0	20.8	24.0		
														2181	1.76	8.1	9.9	12.8	15.1	18.1	22.2	25.6		
														2204	1.87	9.1	11.2	14.4	17.1	20.3	25.0	28.8		
														2226	1.98	10.1	12.4	16.0	18.9	22.6	27.7	32.0		
														2341	2.40	15.2	18.6	24.0	28.4	34.1	41.5	47.9		
														2456	2.76	20.4	25.0	32.2	38.2	45.4	55.8	64.5		
														2682	3.42	30.5	37.4	48.2	57.1	67.9	83.5	96.4		

The table on the next page shows the correspondence between the nominal capacities in U.S. gallons per minute at 40 psi, this is commonly used to identify high pressure washing nozzles and the PNR capacity code at 100 bar. See the following page for dimensions and assembly accessories that accompany high pressure washing nozzles.

OUTER DIMENSIONS OF F TYPE NOZZLES AND FX NOZZLE TIPS

US Gals	PNR Code
02	1460
03	1686
04	1930
045	2103
05	2116
055	2126
06	2138
065	2149
07	2160
075	2170
08	2181
09	2204
10	2226
12	2272
12.5	2280
13	2296
15	2341
20	2456
30	2682

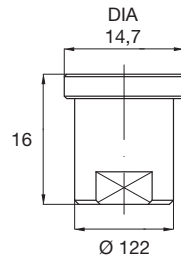

FX

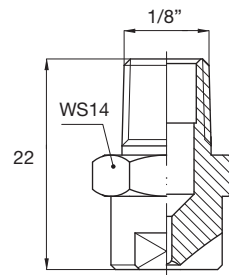

FA

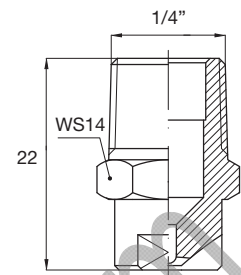

FB

High pressure washing accessories

We supply a range of quality guns and lances designed for high pressure washing applications in our Accessories catalogue (code CTG AC).



UMW 0010 D4



UMW 0020 D4



UMW 0030 B31



UMW 0045 B31

Flow straightener

We can also supply on request our FX tips which are complete with an inside stainless steel flow straightener to help improve jet efficiency.

